

The Trimley Estate

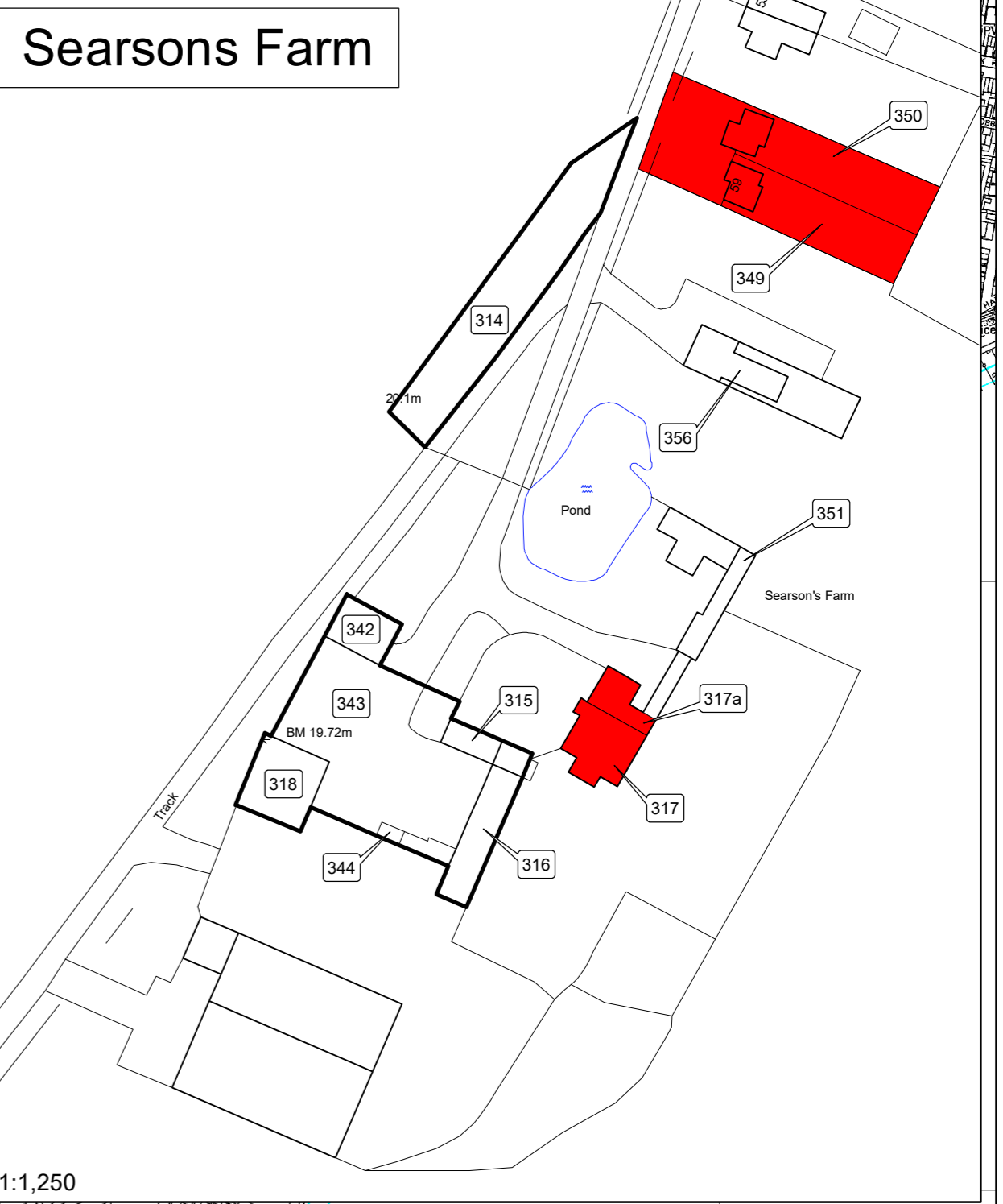
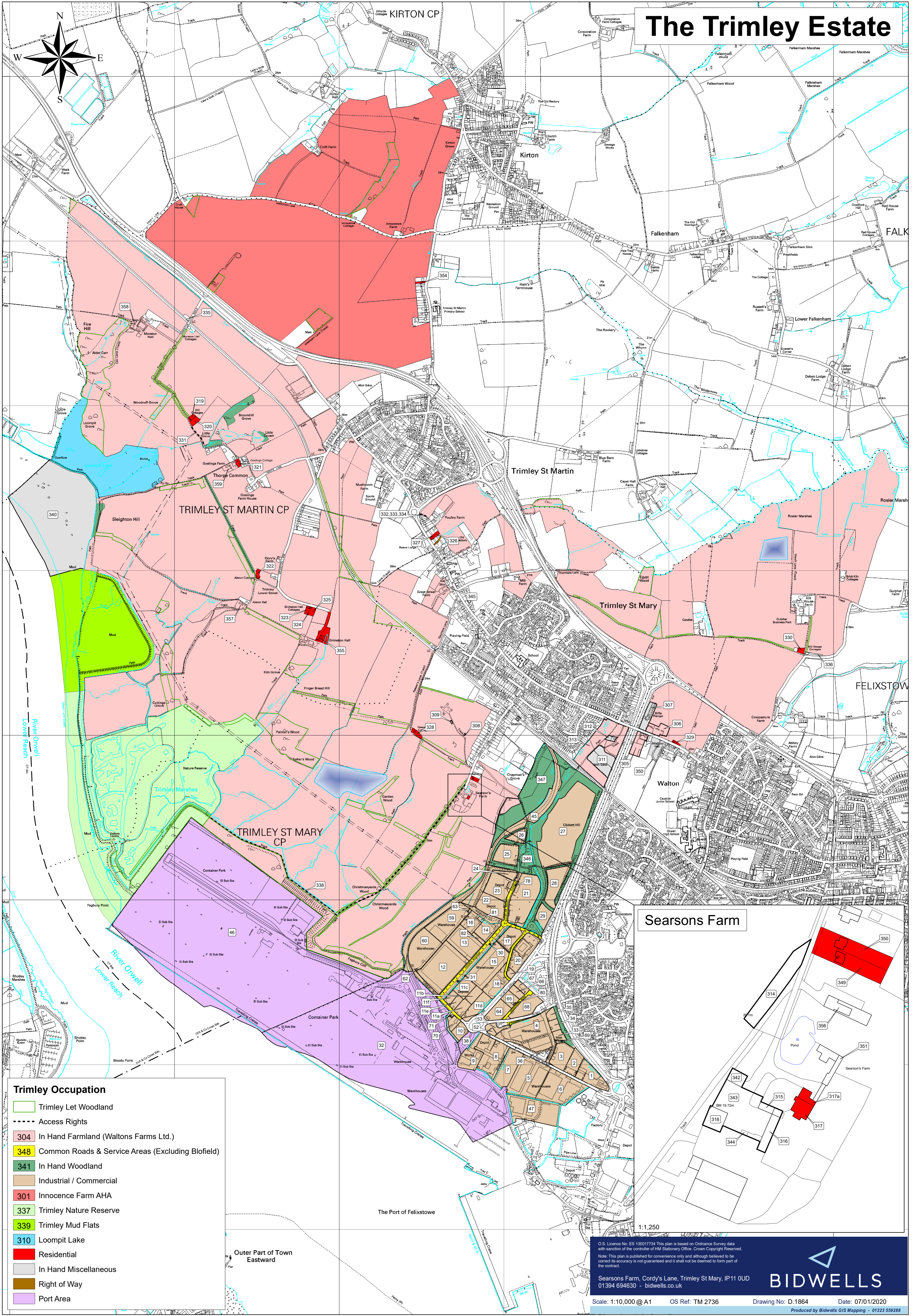

- Trimley Occupation**
- Trimley Let Woodland
 - Access Rights
 - 304 In Hand Farmland (Waltons Farms Ltd.)
 - 348 Common Roads & Service Areas (Excluding Blofield)
 - 341 In Hand Woodland
 - Industrial / Commercial
 - 301 Innocence Farm AHA
 - 337 Trimley Nature Reserve
 - 339 Trimley Mud Flats
 - 310 Loompit Lake
 - Residential
 - In Hand Miscellaneous
 - Right of Way
 - Port Area

O.S. Licence No: ES 10017734 This plan is based on Ordnance Survey data with sanction of the controller of HM Stationery Office. Crown Copyright Reserved.
 Note: This plan is published for convenience only and although believed to be correct its accuracy is not guaranteed and it shall not be deemed to form part of the contract.

Searsons Farm, Cordy's Lane, Trimley St Mary, IP11 0UD
 01394 694630 - bidwells.co.uk

BIDWELLS

Scale: 1:10,000 @ A1 OS Ref: TM 2736 Drawing No: D.1864 Date: 07/01/2020
 Produced by Bidwells GIS Mapping - 01223 559288